

additional wall underlay
over wrap above
extended 200 ea
side of opening

galv, metal
angle lintel

side facing

NOTE:
BI-FOLD LINTELS TO BE ENGINEERED TO TAKE
SASH & DOOR WEIGHT.

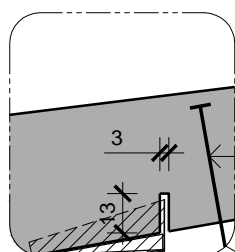

Alternative Sill Flashing
For Timber & Concrete

side facing

window seal
tape continuous
on sill 200mm
up jamb

5mm packers
on sill @ 400 C/C

architectural
sill

do not seal
brick sill
15° slope

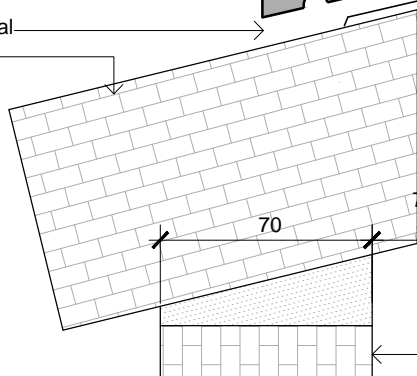

70 max
40 min

Window Sill

Scale: 1:2.5

GIB board

timber lintel
by others

wall underlay pressed
into opening with flexible
flashing tape installed over
wrap to corners at head

continuous air seal

packers

screw fixing (see note)

architrave

6006

7003

7034

Varies

Window Head

Scale: 1:2.5

jamb

5020

Varies

sill flashing turned
up at each end and
sealed

architrave

cold sealant behind
continuous flashing
- ends turned up 20mm

continuous air seal

sill packer

timber framing

GIB board

building wrap

insulation

additional wall underlay

brick veneer, 40 min cavity
(70 max)

Cladding Type:

Brick Veneer

Window / Door Type:

Bi-Folding Windows



NEW ZEALAND LIMITED
JMF New Zealand Limited
20 Cambridge Terrace
Taradale, Napier 4112. NZ

Installation Drawings

Sheet: 1 of 2

Issue: E

A06-21

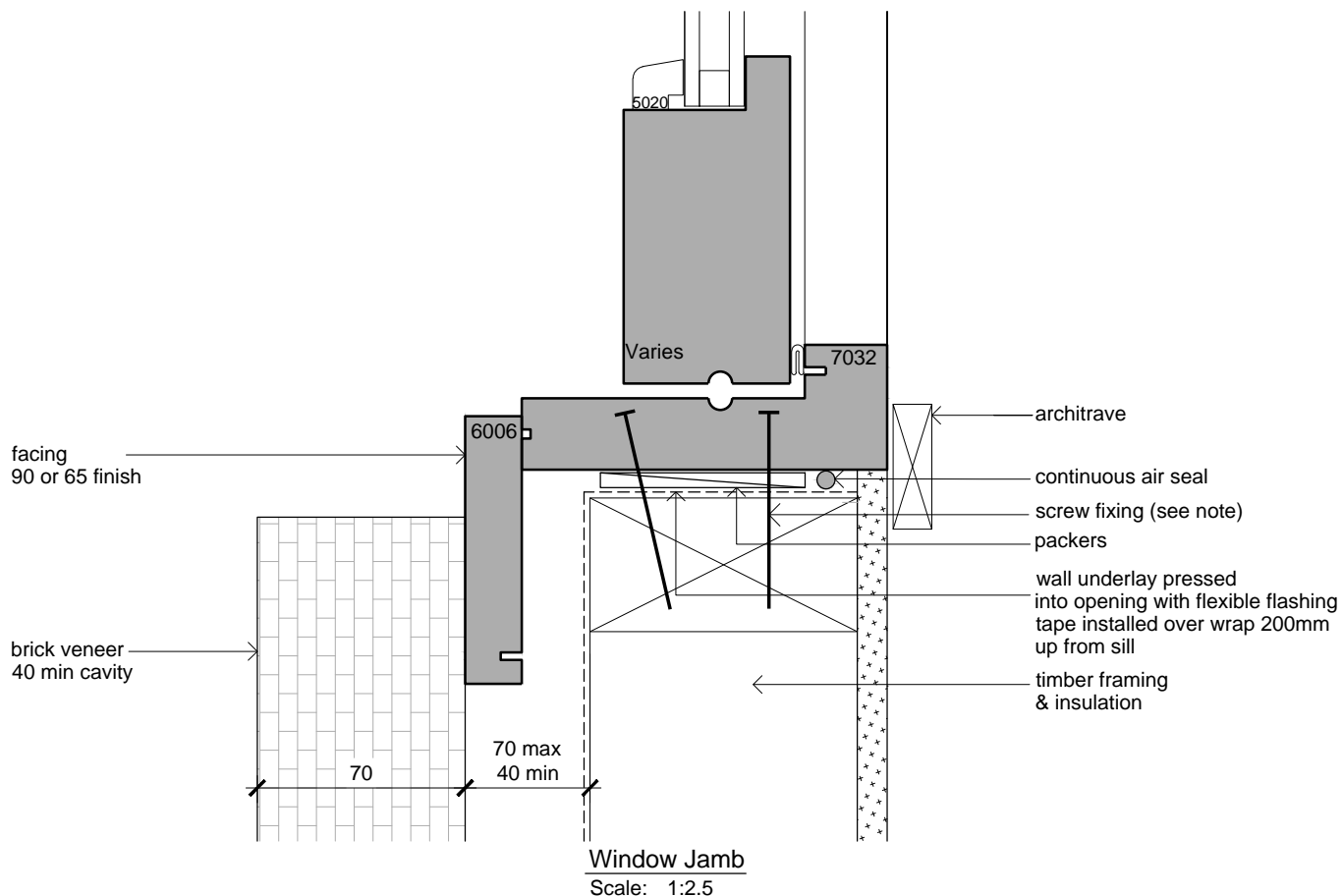

NOTE:
 1. COLD SEALANT NEUTRAL CURE MODIFIED SILICONE.
 2. SCREW OR NAIL FIXING JAMBS 200mm FROM HEAD AND SILL MAXIMUM 600 CENTRES.
 3. SILL FLASHINGS TURNED UP 20mm AT EACH END OF FRAMES AND SEALED.
 4. FIXING THROUGH SILL AS SHOWN ON DRAWINGS.
 5. SITE FIXED FACINGS MUST HAVE COLD SEALANT BETWEEN FACING AND JAMB.

Cladding Type:

Brick Veneer

Window / Door Type:

Bi-Folding Windows

JMF
 NEW ZEALAND LIMITED
 JMF New Zealand Limited
 20 Cambridge Terrace
 Taradale, Napier 4112. NZ

Installation Drawings

Sheet: **2 of 2**

Issue: **E**

A06-21